

DUAL-CURED CORE BUILD-UP MATERIAL

# CLEARFIL™ DC CORE PLUS

**EASY! STRONG! CONFIDENT!** *The Sensation of Core Build-up Material.*

**CLEARFIL DC CORE PLUS** is a dual-cure, radiopaque two-component core build-up material supplied in a convenient automix delivery system.

**CLEARFIL DC CORE PLUS** has superior compressive and flexural strength with a filler loading of 74wt%.

**CLEARFIL DC CORE PLUS** cuts like dentin when being prepared, and affords long-term durability.

Core build-ups are faster, easier and stronger than ever when used with our one-step bonding agent:

**CLEARFIL S<sup>3</sup> BOND PLUS**, also offering the added benefits of fluoride release.

**CLEARFIL DC CORE PLUS** provides the dentist with the confidence of durable, lasting restorations.

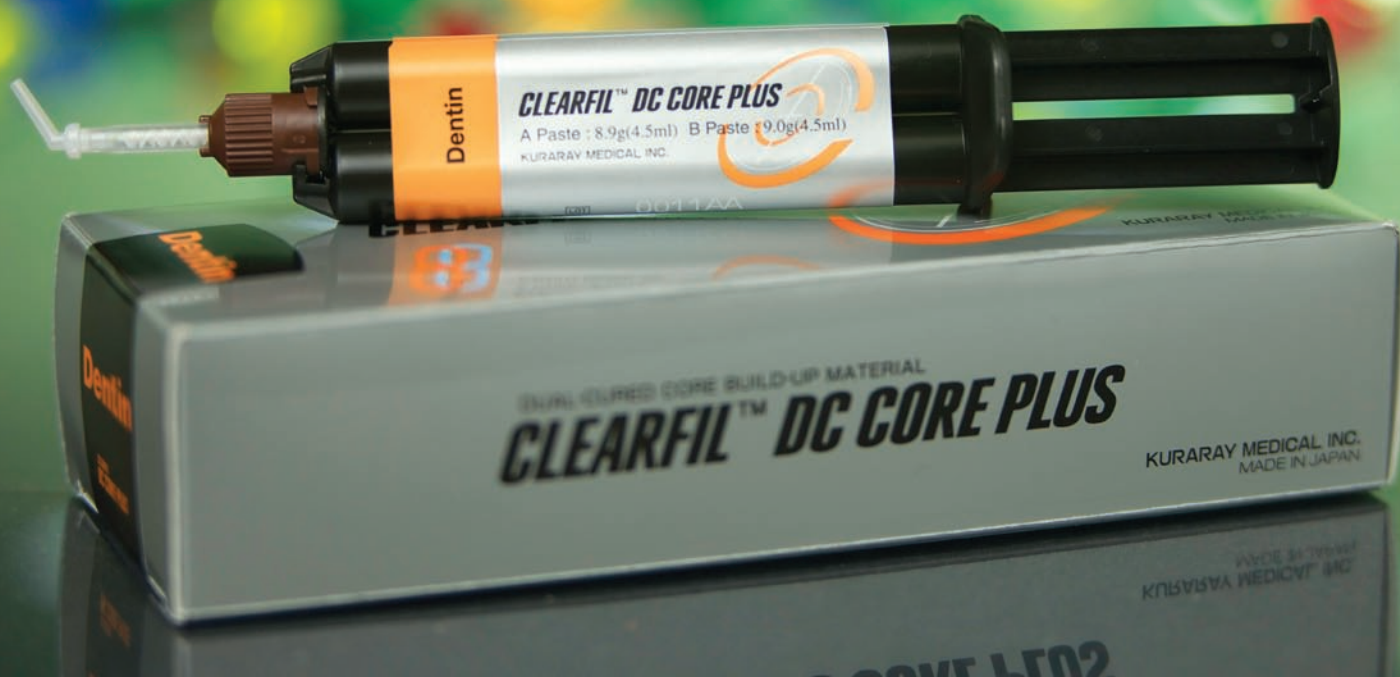

**kuraray**

DUAL-CURED CORE BUILD-UP MATERIAL

# CLEARFIL™ DC CORE PLUS

*With a Strong Core... comes the confidence of a Great Restoration.*

- Excellent and Desired Physical Properties
- Superior Bond Strength with **CLEARFIL S<sup>3</sup> BOND PLUS**
- Flows with Control; No Matrix Band Needed
- Specially Designed Guide Tip for Deep Root Canals
- Long-Term Durability
- Post Cementation
- Cuts and Feels like Dentin
- Radiopaque

Tensile Bond Strength to Dentin (MPa)

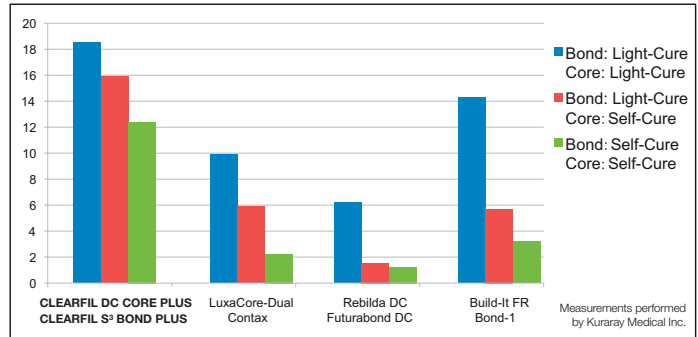

## SIMPLE APPLICATION:

Post cementation and core build-up using **CLEARFIL DC CORE PLUS** and **CLEARFIL S<sup>3</sup> BOND PLUS**

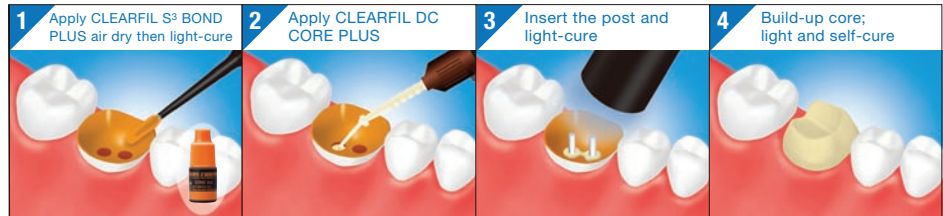

## ORDERING INFORMATION:

ITEM#	PRODUCT NAME	CONTENTS
#2942KA	CLEARFIL DC CORE PLUS (Dentin)	1 Automix Syringe <ul style="list-style-type: none"> <li>• A Paste (8.9 g, 4.5 ml)</li> <li>• B Paste (9.0 g, 4.5 ml)</li> </ul> 20 Mixing Tips 10 Guide Tips (L) 10 Guide Tips (S)
#2943KA	CLEARFIL DC CORE PLUS (White)	1 Automix Syringe <ul style="list-style-type: none"> <li>• A Paste (8.9 g, 4.5 ml)</li> <li>• B Paste (9.0 g, 4.5 ml)</li> </ul> 20 Mixing Tips 10 Guide Tips (L) 10 Guide Tips (S)

## RELATED PRODUCTS:

**CLEARFIL S<sup>3</sup> BOND PLUS** is a light-cure, self-etching, one-step, fluoride-releasing bonding agent. Based on the same progressive adhesive technologies from the gold standard; **CLEARFIL SE BOND** you can expect minimal postoperative sensitivity.

A perfect combination with **CLEARFIL DC CORE PLUS!**



## ACCESSORIES

#1029KA  
CLEARFIL DC CORE PLUS  
Guide Tip (L) 20 pcs

#1030KA  
CLEARFIL DC CORE PLUS  
Guide Tip (S) 20 pcs

#1031KA  
CLEARFIL DC CORE PLUS  
Mixing Tip 20 pcs

#2832KA  
CLEARFIL DISPENSER  
(10 ml) 1 pc

Warranty: KURARAY MEDICAL INC. will replace any product that is proved to be defective. Neither KURARAY MEDICAL INC. nor the distributor accepts liability for any loss or damage, direct, consequential or special, arising out of the application or use of or the inability to use these products. Before using, the user should determine the suitability of the products for the intended use and the user assumes all risk and liability whatsoever in connection therein. CLEARFIL™ DC CORE PLUS and KURARAY MEDICAL INC. products are available only through Kuraray Authorized dealers.

CLEARFIL™ is a trademark of KURARAY Co.,Ltd.