

DUAL-CURED CORE BUILD-UP MATERIAL

# **CLEARFIL™ DC CORE PLUS**

---

**EASY! STRONG! CONFIDENT!**  
The Sensation of Core Build-up Material.



CLEARFIL™ DC CORE PLUS is a dual-cure (light-cure with self-curing property) core build-up material. The self-curing property is the perfect solution for those areas of root canal, which are not accessible for light. The special filler technology in CLEARFIL™ DC CORE PLUS gives the material an optimal thixotropy. As a result of this, you can apply the paste without effort. The non-slumping formula guarantees the paste will not be runny. For all steps, applying to root canal and core build-up, you can easily use only one mixing tip – thanks to the three-minute working time.

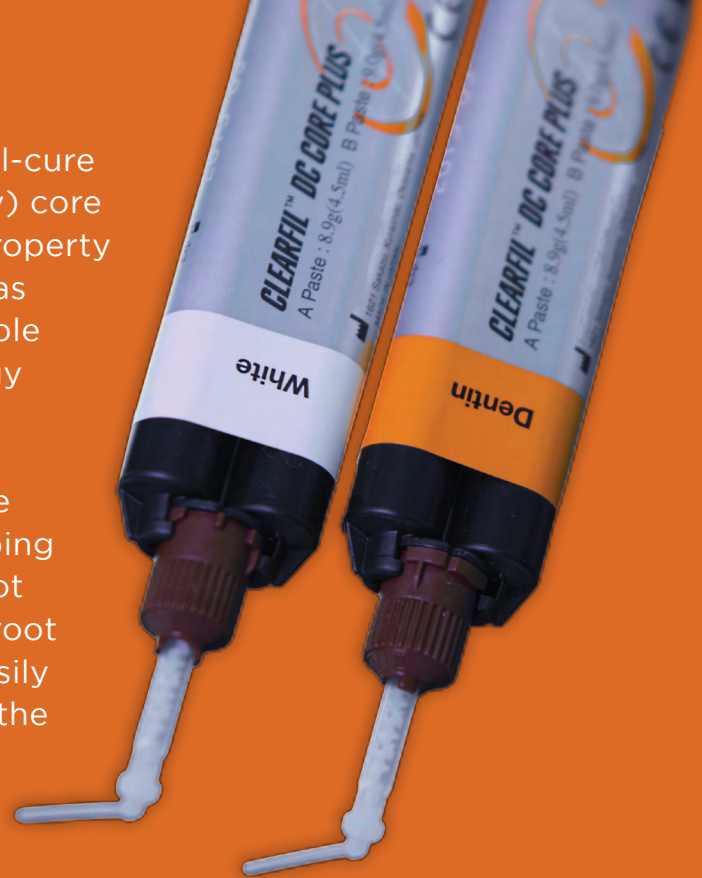

- ✔ Easy to use procedure
- ✔ Dual-cure
- ✔ Apply without effort
- ✔ 'Non-slumping formula'
- ✔ Three minutes working time

## FLEXURAL STRENGTH

CLEARFIL™ DC CORE PLUS shows the highest flexural strength in comparison to other core build-up materials.

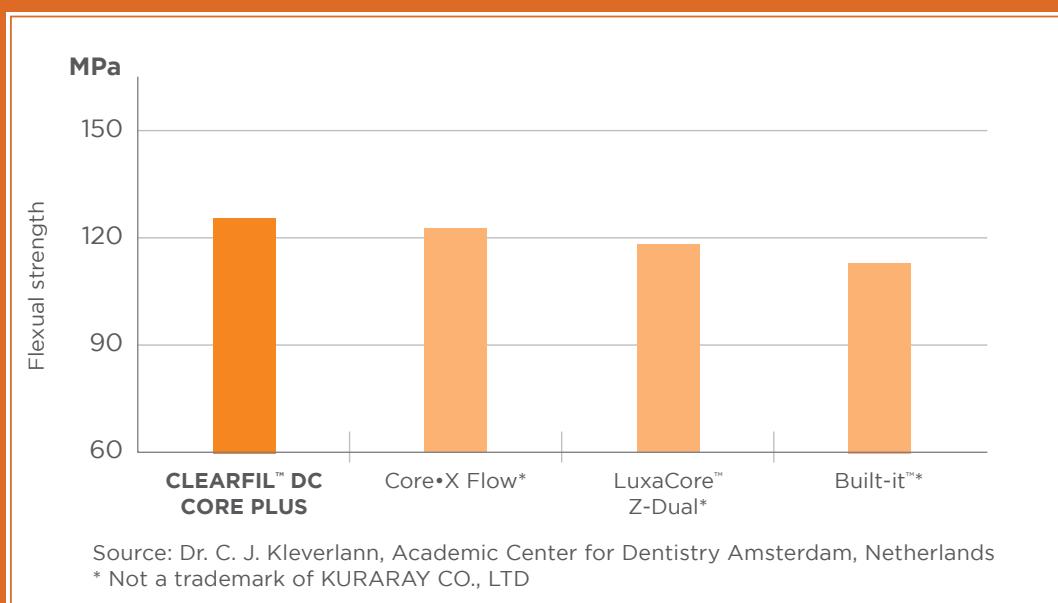

## BALANCED MATERIAL CHARACTERISTICS

To avoid high occlusal stress to the end of the root, CLEARFIL™ DC CORE PLUS has an elastic modulus close to that of dentin. So the occlusal stress is dispersed on the complete surface of the root canal. Furthermore, despite of the chewing stress a stable restoration is ensured – thanks to the high mechanical properties of CLEARFIL™ DC CORE PLUS. Thus a minimal risk of root and core build-up material fracture can be assured.

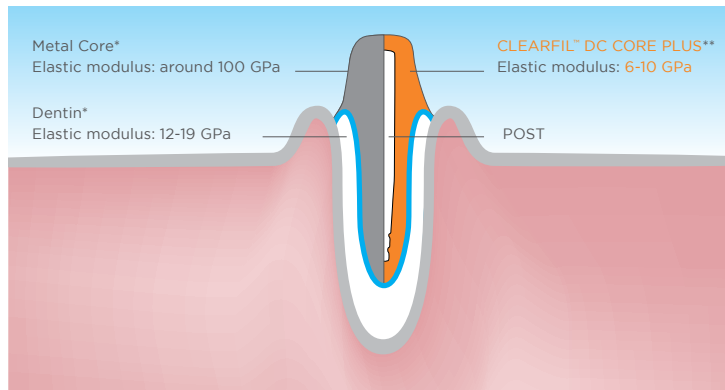

\* Source: S. Takahasi, T. Hirashawa, et. al, J. J. Dent Material Vol. 16(6), 555-562, 1996.  
\*\* Source: Kuraray Medical Inc.

## FLOWS WITH CONTROL

The paste is easy to dispense and easy to control, due to the unique filler surface treatment technology of CLEARFIL™ DC CORE PLUS.

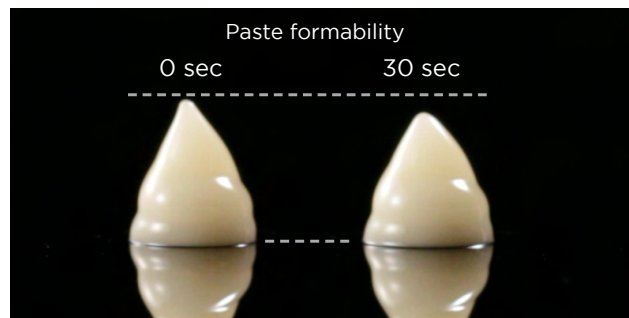

CLEARFIL™ DC CORE PLUS is available in the following shades:

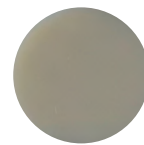

Dentin



White

# EASY TO USE, STRESS-LESS CLINICAL PROCEDURE

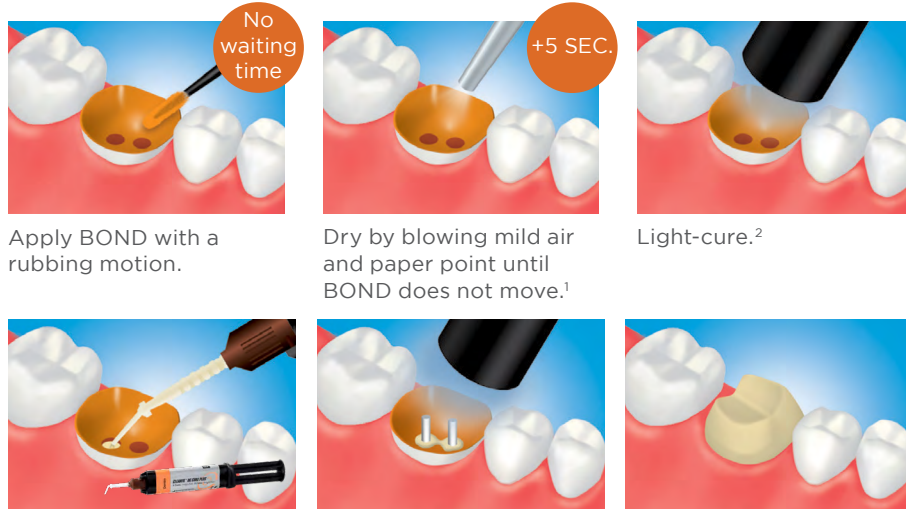

Apply BOND with a rubbing motion.

Dry by blowing mild air and paper point until BOND does not move.<sup>1</sup>

Light-cure.<sup>2</sup>

Post cementation and core build-up using CLEARFIL™ DC CORE Plus according to the manufacturer's instructions.

<sup>1</sup> Use a vacuum aspirator to prevent BOND from scattering

<sup>2</sup> Refer to the Table 1 for light-curing time.

**NOTE:** This is an abbreviated version. Please follow the Instructions for Use

## THE PERFECT TEAM FOR RELIABLE CORE BUILD-UPS



Due to its outstanding adhesion properties, CLEARFIL™ Universal Bond Quick is the perfect complement to CLEARFIL™ DC CORE PLUS. Because of its specific accelerator for self-curing, it is ideal for those areas which could not be reached by light. CLEARFIL™ Universal Bond Quick adheres to dentin in the root channel and the post. A separate primer is not needed.

## ORDERING INFORMATION



**#2942-KA** (Dentin)  
**#2943-KA** (White)  
 1 x CLEARFIL™ DC CORE PLUS  
 1 Automix Syringe  
 • A Paste (8.9 g, 4.5 ml)  
 • B Paste (9.0 g, 4.5 ml)  
 20 Mixing Tips  
 10 Guide Tips (L)  
 10 Guide Tips (S)



**#1029KA**  
 CLEARFIL™ DC CORE PLUS  
 Guide Tip (L) 20 pcs



**#1030KA**  
 CLEARFIL™ DC CORE PLUS  
 Guide Tip (S) 20 pcs



**#1031KA**  
 CLEARFIL™ DC CORE PLUS  
 Mixing Tip 20 pcs

### YOUR CONTACT

#### Kuraray America, Inc.

32 Old Slip Phone (800) 879-1676  
 Floor 7 Fax (888) 700-5200  
 New York, NY 10005 E-mail info@kuraraydental.com  
 Website www.kuraraydental.com

- Before using this product, be sure to read the Instructions for Use supplied with the product.
- The specifications and appearance of the product are subject to change without notice.
- Printed color can be slightly different from actual color.

"CLEARFIL" is a registered trademark or trademarks of KURARAY CO., LTD.



**Kuraray Noritake Dental Inc.**

1621 Sakazu, Kurashiki, Okayama 710-0801, Japan

R Only



CE 0120