

kuraray

CLEARFIL™ DC BOND

A Self-Etching, Dual-Cure Bonding Agent

One bonding agent for most bonding procedures

- **Strong enamel bond strengths (equal to or stronger than total-etch bonding agents)**
- **Virtually no post-operative sensitivity**
- **Bonds to all light, self & dual-cure restorative composites, core build-up composites & resin cements for all direct & indirect restorations**
- **Easy one application procedure**
- **Low film thickness (5 -10 microns)**
- **Dentin sealing adhesive for indirect restoration**
- **No bad taste from phosphoric acid**



KURARAY AMERICA, Inc.

600 Lexington Avenue, New York, NY 10022 | 800.879.1676 | kuraraydental.com | ©2008 Kuraray America, Inc.

Clinical Indications

- Core build-ups using light, dual, or self-cure composite resins
- Direct restorations using light, self or dual-cure composite resin
- Cavity sealing as a pretreatment for indirect restorations
- Treatment of exposed root surfaces for sensitivity
- Intraoral repairs of fractured crowns/bridges made of porcelain, metal oxide ceramics (Zirconia & Alumina), hybrid ceramics, or composite resins

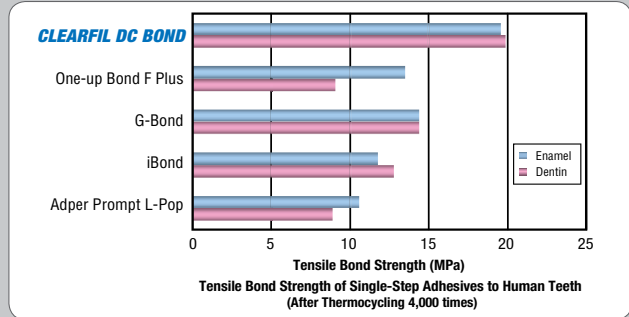
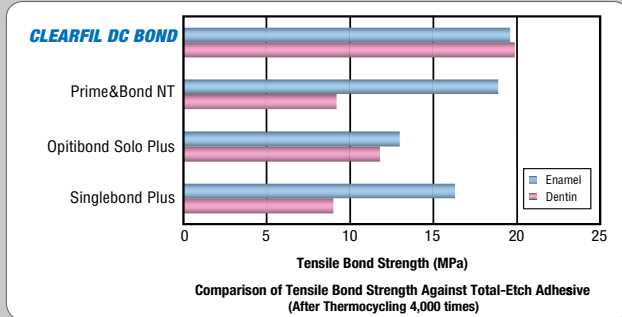

Procedure of direct restorations using light-cure composite (please see complete instructions before using this product)

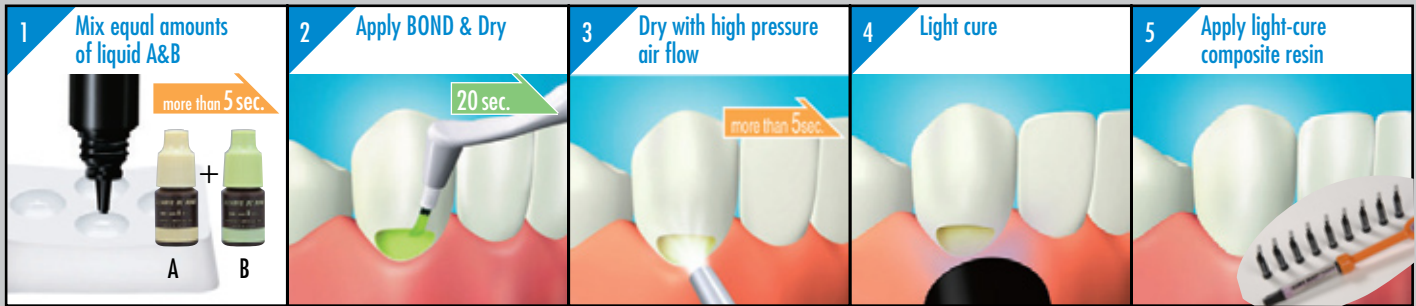

	CLEARFIL™ SE BOND	CLEARFIL™ S3 BOND	CLEARFIL™ DC BOND
Type of Cure	LIGHT	LIGHT	DUAL (LIGHT/SELF)
BOTTLE DELIVERY	•	•	•
SINGLE DOSE DELIVERY		•	
FILM THICKNESS (µm)	50 - 100	5 - 10	5 - 10
NUMBER OF BOTTLES	2	1	2
NUMBER OF STEPS	2	1	1
Indirect Indications *			
VENEERS			•
COMPOSITE & PORCELAIN INLAYS / ONLAYS			•
CROWNS & BRIDGES			•
POST			•
Direct Indications			
COMPOSITE	•	•	•
CORE BUILD-UP	•**	•**	•
PORCELAIN REPAIR	•	•	•
Bond Strengths (MPa)			
DIRECT TO DENTIN	22.1	20.2	19.1
DIRECT TO ENAMEL	19.4	17.7	18.3
INDIRECT TO DENTIN*	N/A	N/A	15.6
INDIRECT TO ENAMEL*	N/A	N/A	22.9

* with CLEARFIL ESTHETIC CEMENT; ** Light-cure only

Related Products:



2520 KA CLEARFIL ESTHETIC CEMENT & DC BOND KIT

- CLEARFIL™ ESTHETIC CEMENT & DC BOND KIT
- Virtually no post-operative sensitivity
- Extraordinarily easy to use with automix dispensing system
- Try-in paste accurately matches the cement color and film thickness
- Bond strength higher than most other cements, including the industry-standard PANAVIA
- Minimum shade selection for very wide applications
- Superior physical properties, including strong wear resistance



362 KA CLEARFIL DC CORE AUTOMIX (White)
363 KA CLEARFIL DC CORE AUTOMIX (Dentin)

- CLEARFIL DC CORE AUTOMIX™
- Superior compressive strength
- Superior flexural strength
- Dual-cure composite
- Cuts like dentin
- Long-term durability
- Not sticky
- Radiopaque
- Easy application with automix syringe

CLEARFIL™ DC BOND Products

Item Number	Product Name	Contents
#2510KA (Set)	CLEARFIL™ DC BOND	1 BOND Liquid A (4ml) 1 BOND Liquid B (4m) 1 Brush tip handle 1 Mixing dish 1 Disposable brush tips (50pcs.)
#2512KA #2513KA (Refills)	BOND Liquid A BOND Liquid B	1 Bottle (4ml) 1 Bottle (4ml)
#965	Brush tip handle	1
#968	Disposable brush tips	50
#902	Mixing dish	1

Warranty: All data, other than from quoted articles herein, are based on actual measurements performed by Kuraray Medical, Inc. Kuraray Medical Inc. will replace any product that is proved to be defective. Neither Kuraray Medical, Inc. nor the distributor accepts liability for any loss or damage, direct, consequential or special, arising out of the application or use of or the inability to use these products. Before using, the user should determine the suitability of the products for the intended use and the user assumes all risk and liability whatsoever in connection therein. CLEARFIL DC BOND and Kuraray products are available only through Kuraray Authorized dealers. CLEARFIL and CLEARFIL DC CORE AUTOMIX are trademarks of Kuraray Co., Ltd. Prime & Bond NT is a trademark of Dentsply, Optibond is a trademark of Kerr, Singlebond Plus and Adper Prompt L-Pop are trademarks of 3M ESPE, G-Bond is a trademark of GC America, iBond is a trademark of Heraeus Kurzer. One-up Bond is a trademark of Tokuyama. © 2008 Kuraray America, Inc.